

TM 9-2320-242-20-2-2

TECHNICAL MANUAL

VOLUME 2 OF 3

PART 2 OF 2

TROUBLESHOOTING

ORGANIZATIONAL LEVEL

TRUCK, CARGO:

1-1/4-TON, 6x6, M561 (NSN 2320-00-873-5407)

TRUCK, AMBULANCE:

1-1/4-TON, 6x6, M792 (NSN 2310-00-832-9907)

NOTE:

THE STYLE OF THIS TM IS
EXPERIMENTAL. IT IS BEING TRIED
BY THE ARMY ONLY ON
A LIMITED BASIS

HEADQUARTERS, DEPARTMENT OF THE ARMY

NOVEMBER 1980

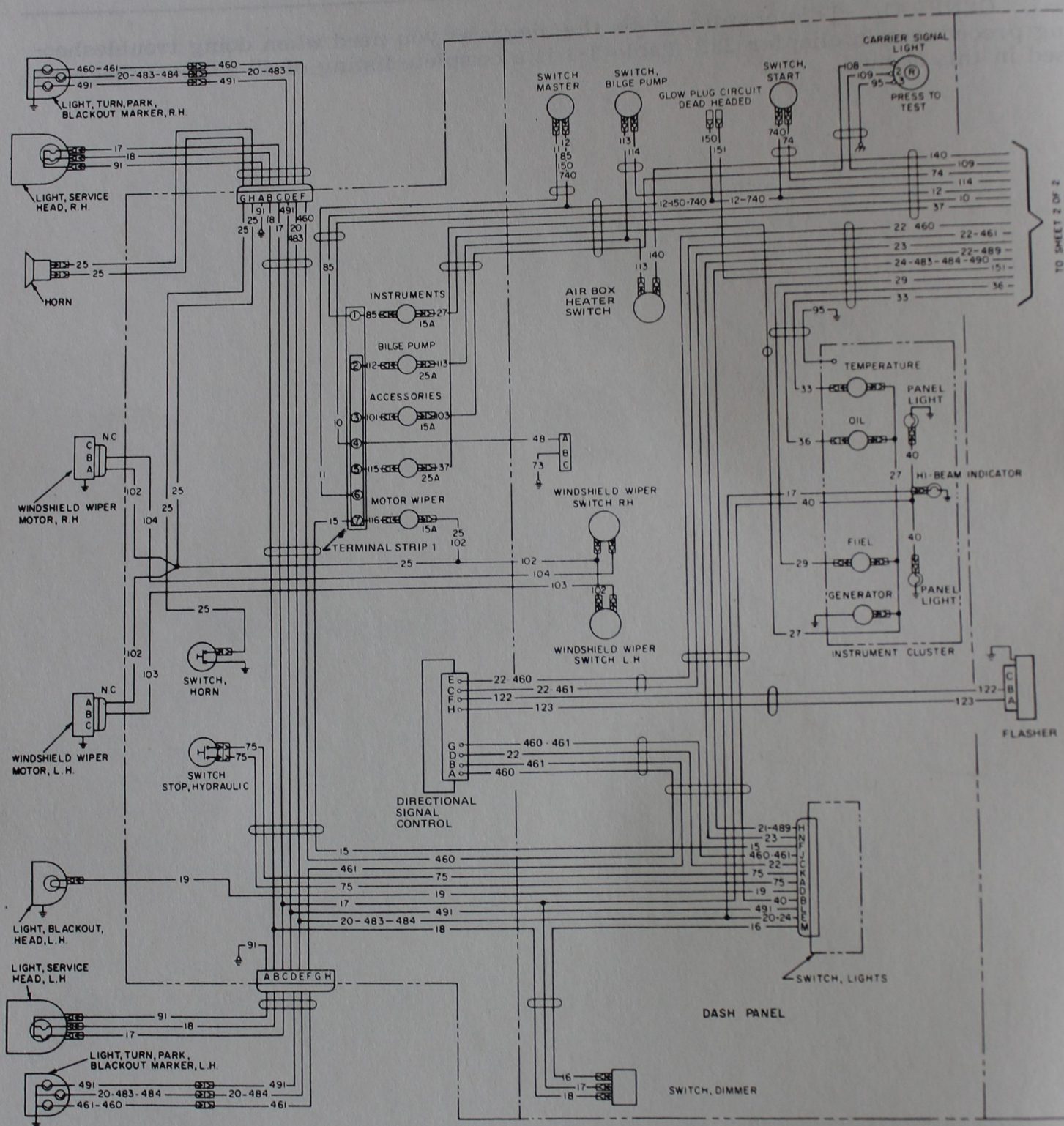

TA 117186

Figure 25-1. Tractor and Carrier Wiring Support Diagram (Sheet 1 of 2)

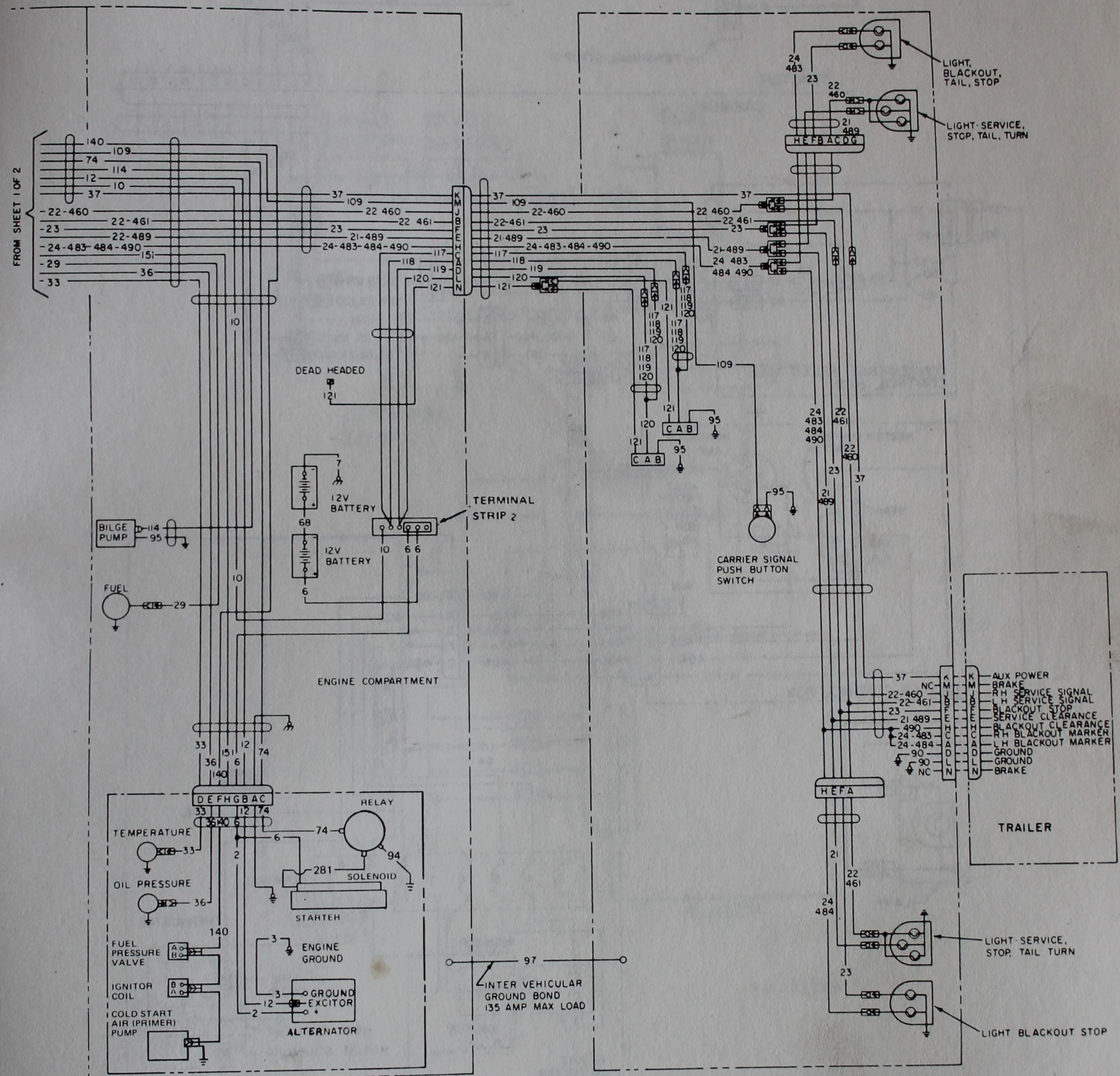
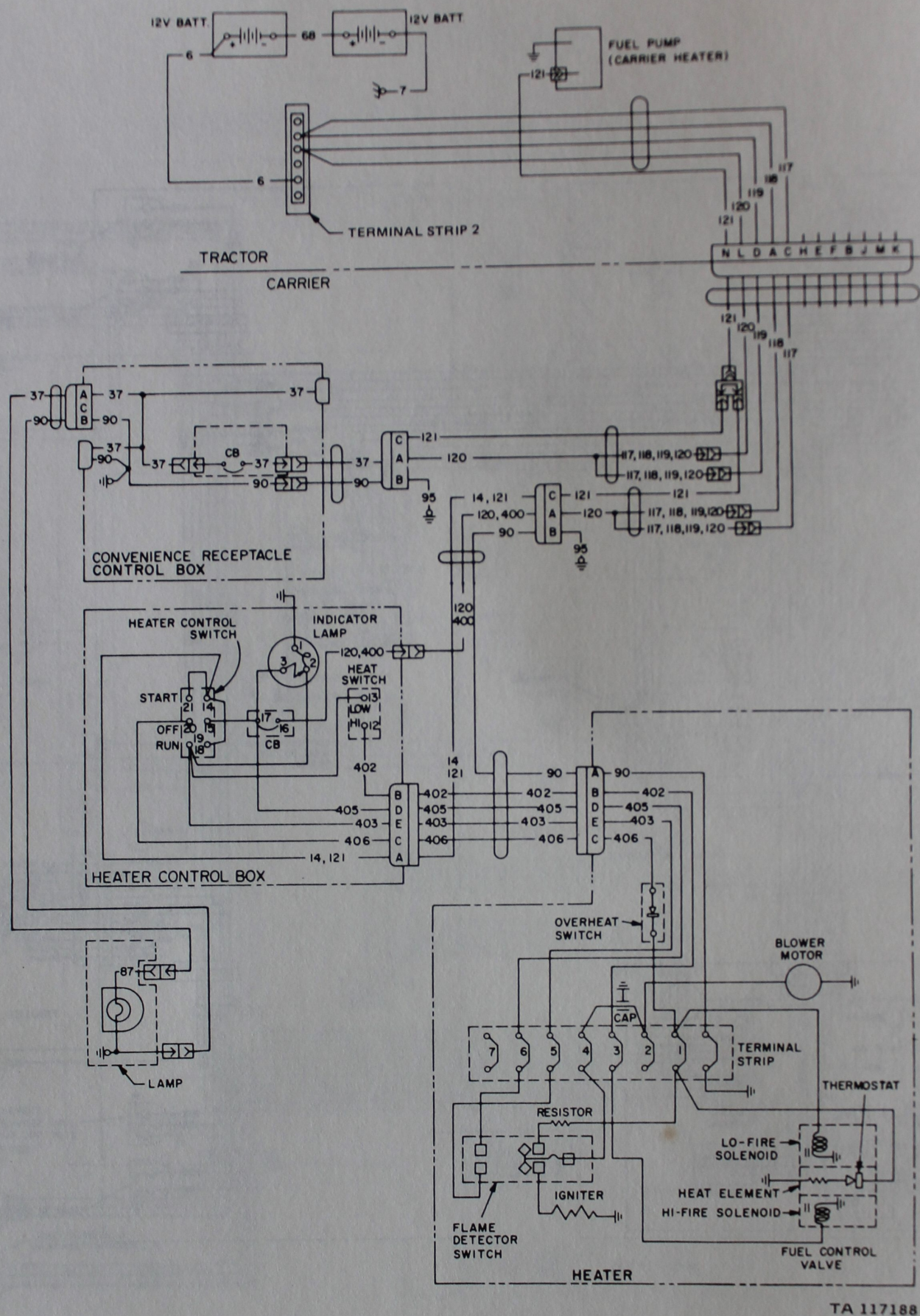
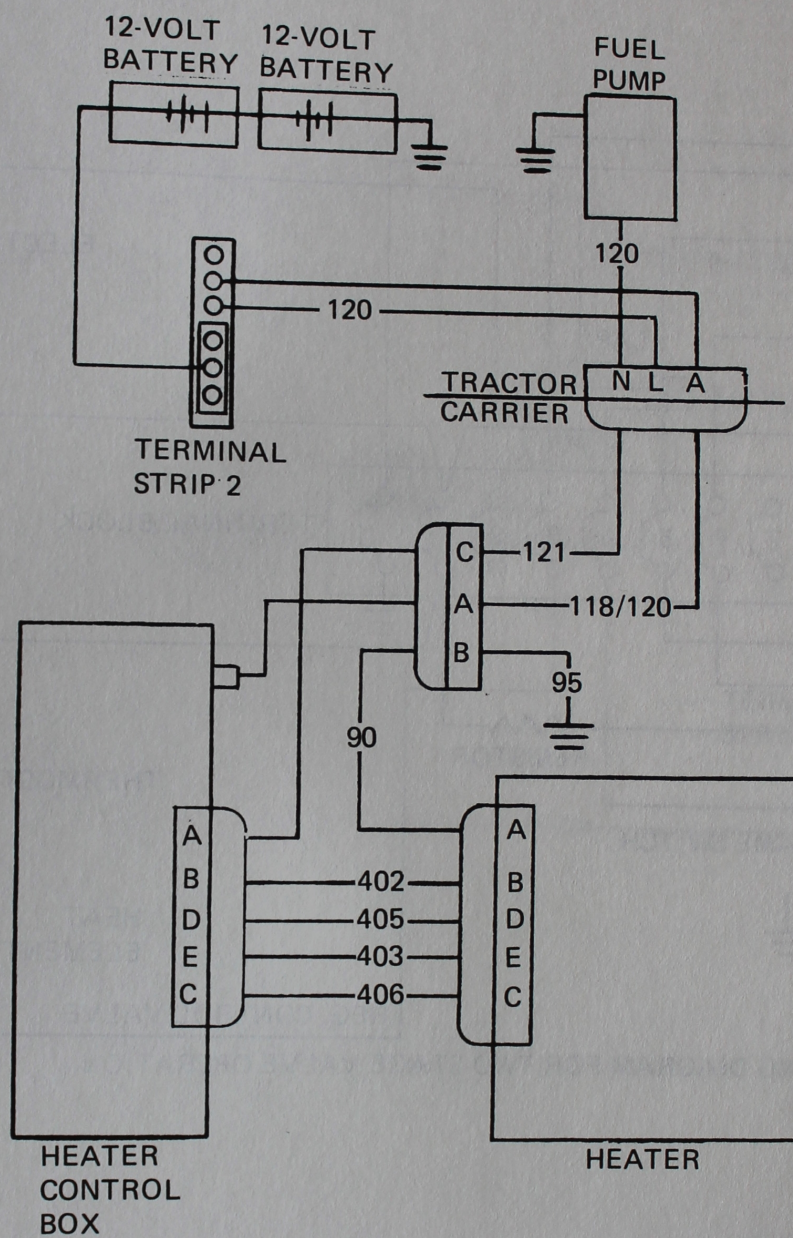

Figure 25-1 Tractor and Carrier Wiring Support Diagram
(Sheet 2 of 2)



TA 117188

Figure 25-2. Carrier Additional Wiring Support Diagram



TA 117189

Figure 25-3. Carrier Personnel Heater Wiring Support Diagram

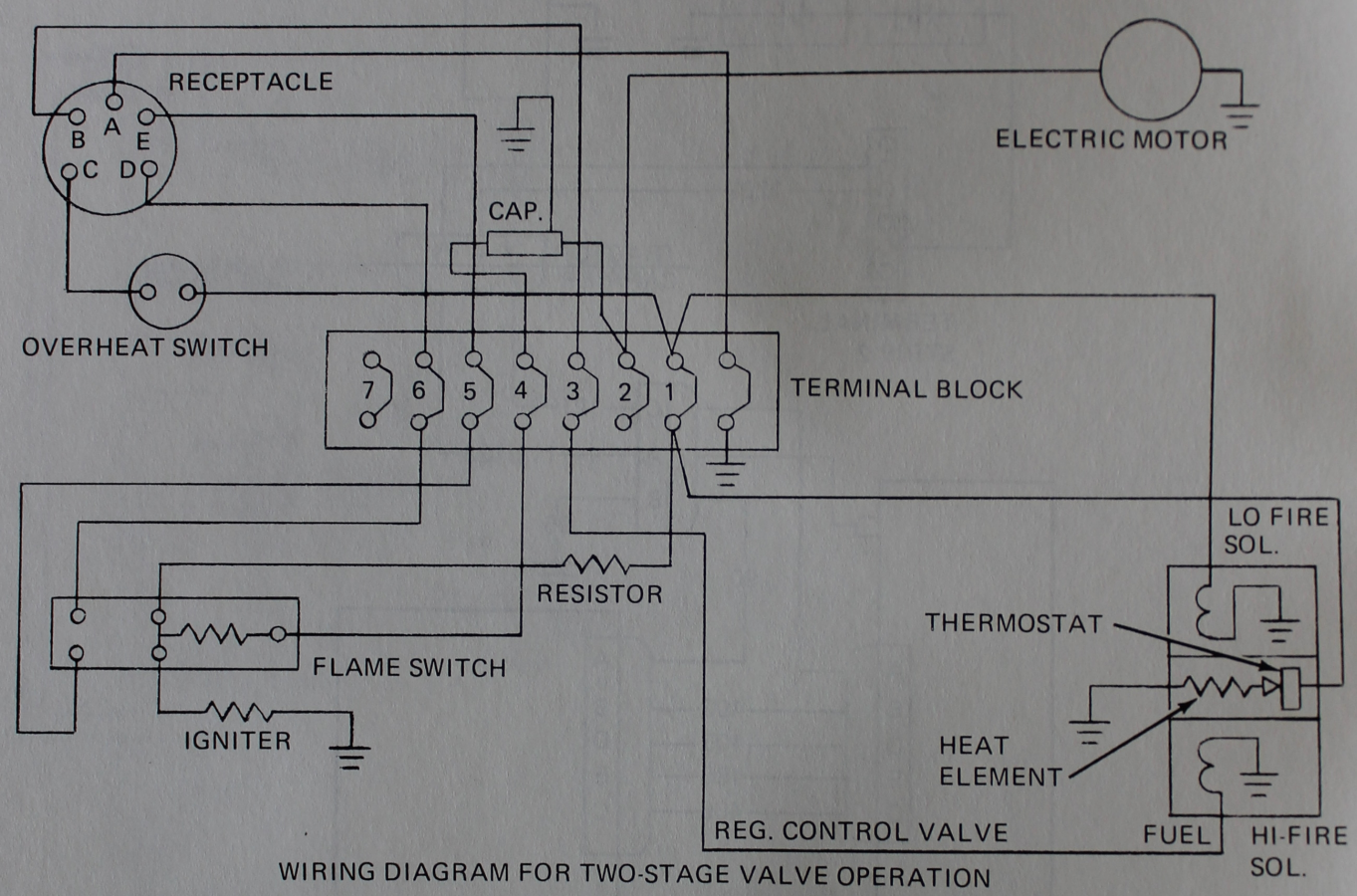

Figure 25-4. Two-Stage Valve Operation Wiring Support Diagram

TA 117190

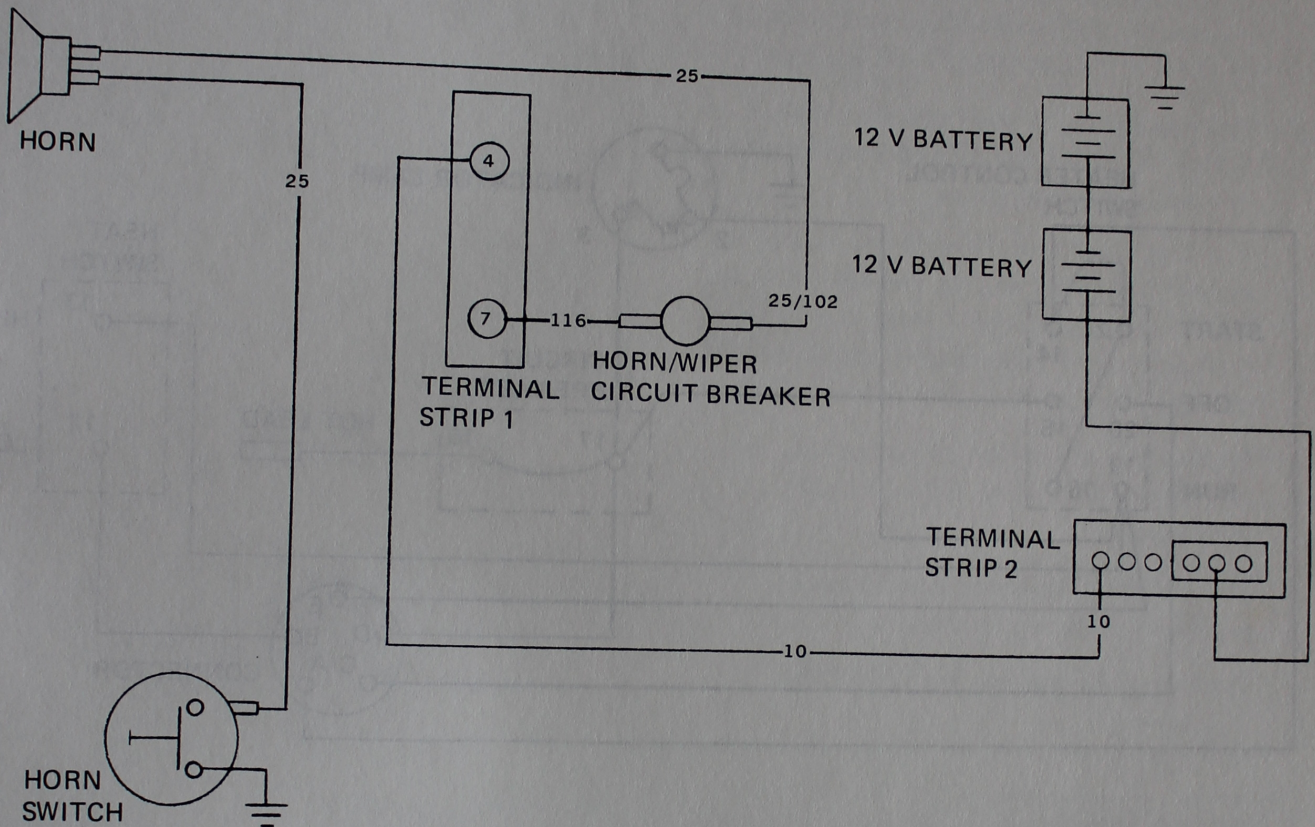

Figure 25-5. Horn System Circuit Wiring Support Diagram

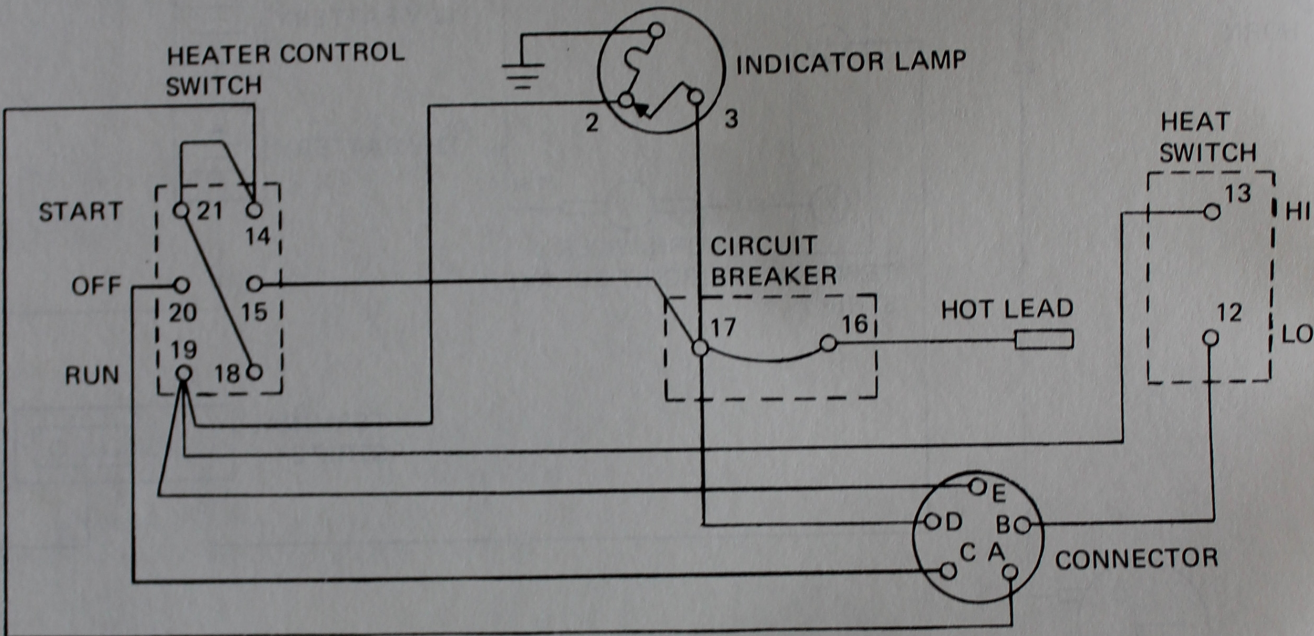
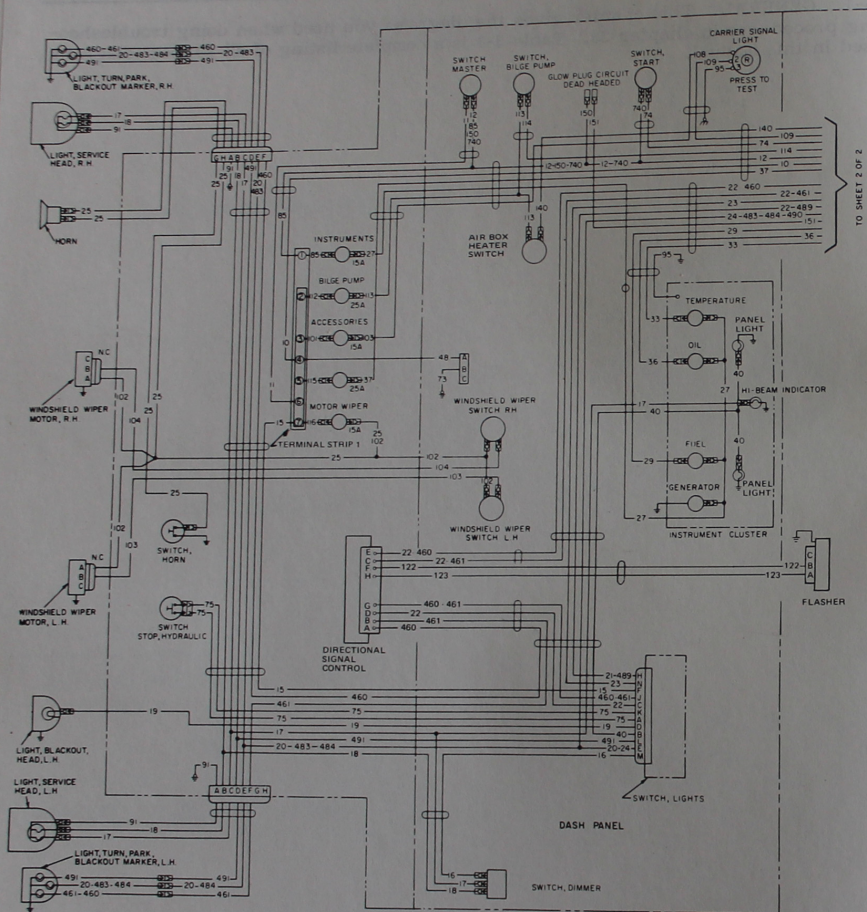

Figure 25-6. Heater Control Box Wiring Support Diagram

TA 115280



TA 117186

Figure 25-1. Tractor and Carrier Wiring Support Diagram (Sheet 1 of 2)

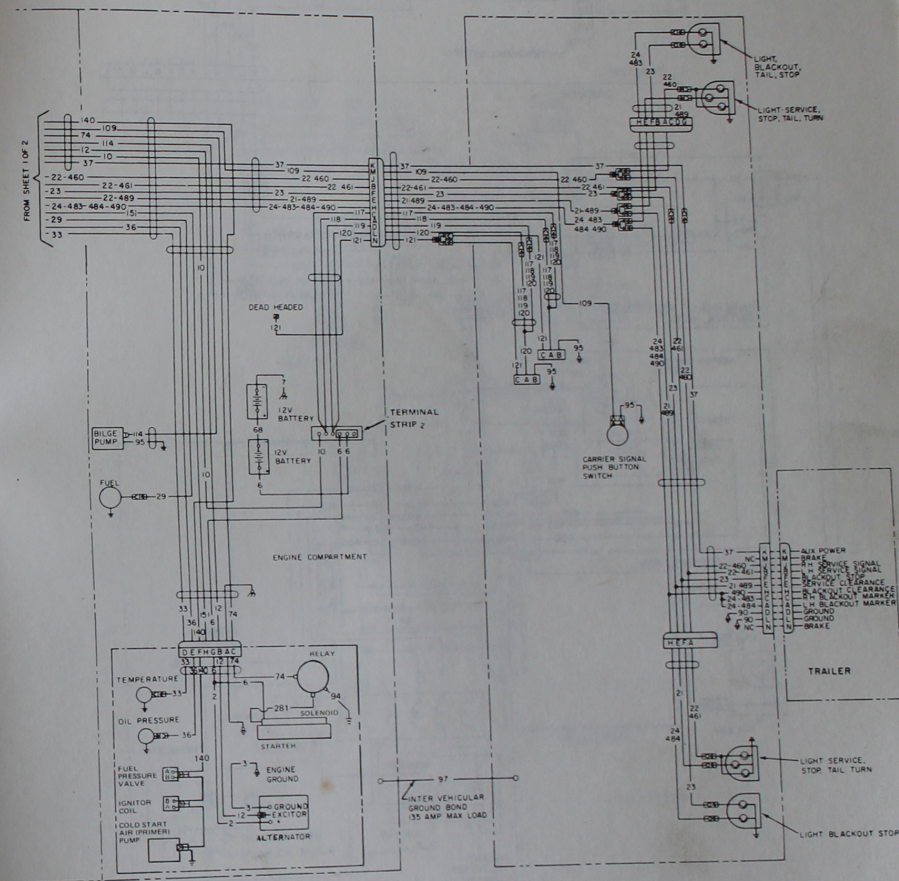

TA 117187

Figure 25-1 Tractor and Carrier Wiring Support Diagram (Sheet 2 of 2)

t. Schematic Wiring Diagrams. Figure 1-8 shows the schematic wiring diagram common to the M561 Cargo Truck and M792 Ambulance. Figure 1-9

shows the additional system wiring for the M792 Ambulance.

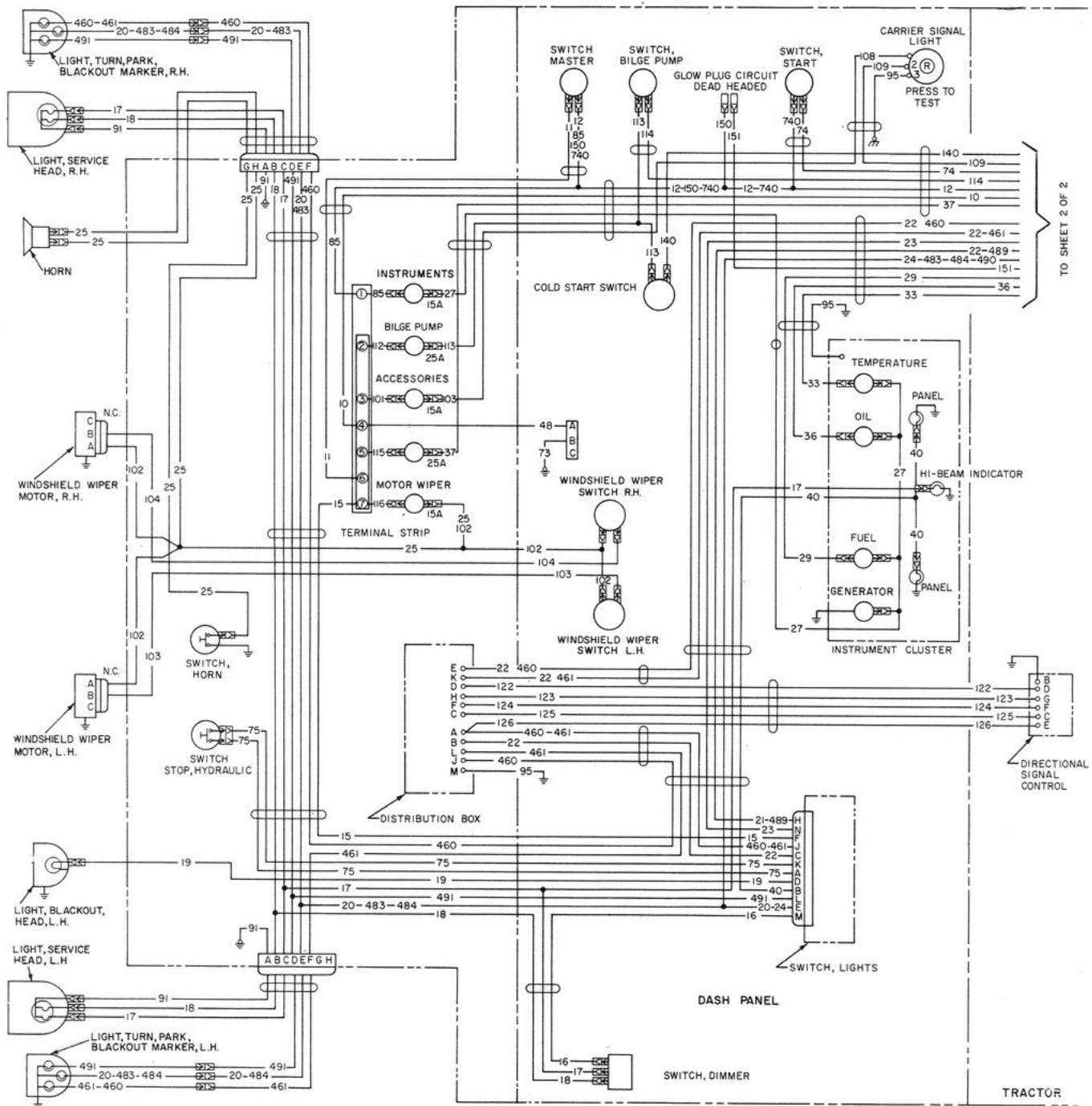

Figure 1-8. Schematic wiring diagram.